

A DOUBLE GLAZED WINDOW THAT HANGS PERFECTLY

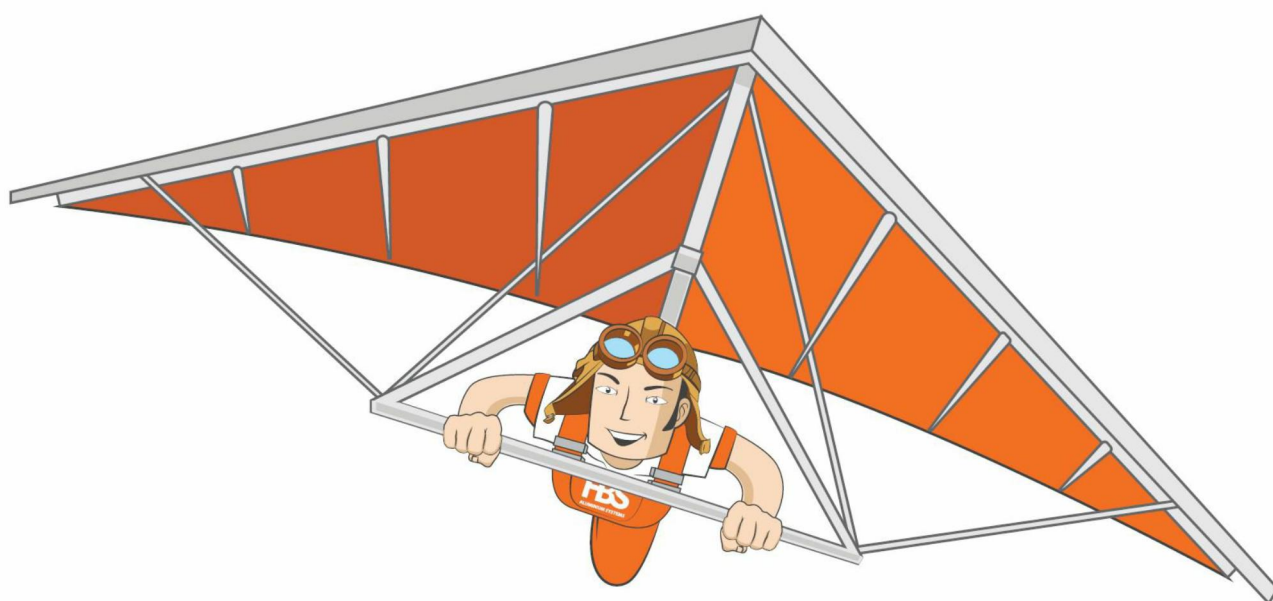

The 40mm casement window hangs perfectly because it was designed with a 16mm stack high friction stay which prevents sagging under the weight of a SIG unit. That's not all, it is waterproof as well.



Double Glazed Casement

- for the Architect

DOUBLE GLAZING CASEMENT WINDOW SYSTEM

41mm structural profiles with in-line flush vents

- Economical double & single glazing Casement system.
- Excellent thermal & acoustic performance.
- Domestic and commercial application
- In-line sash profile sits flush with frame.
- Casement handles or Multi-point locking options.
- Simple re-enforcement allows for 3000mm high products at 1200mm centers.

FRAME CONSTRUCTION OPTIONS

- **Flat screens**

Optional Sill Compensation, Frame Connectors & Re-inforcement



- **Corner construction**



TYPICAL FRAME w. IN-LINE SASH

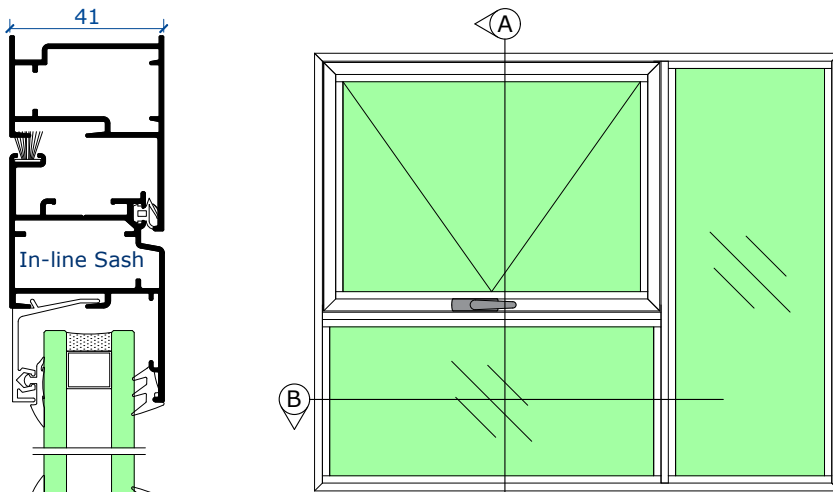

FRAME INSERTS - WINDOWS

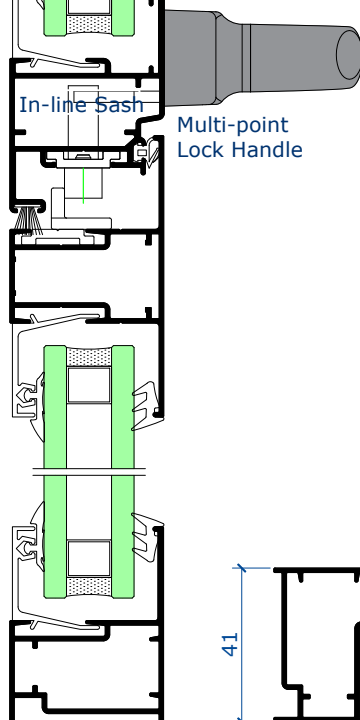
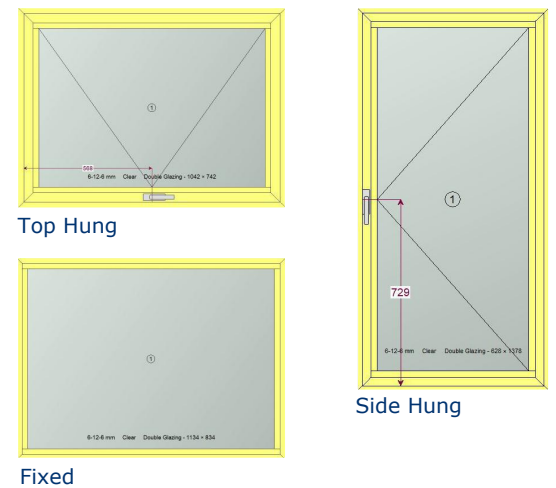

Multi-point Lock Handle

HANDLES

Left Sash Handle

- Available in Silver.



Right Sash Handle

- Available in Silver.



Right or Left Casement Handle



Max. sash size at A3 performance

- 1200 x 900mm (wxh) Top Hung.
- 750 x 1500mm (wxh) Side Hung.

Max. sash weight 80kg

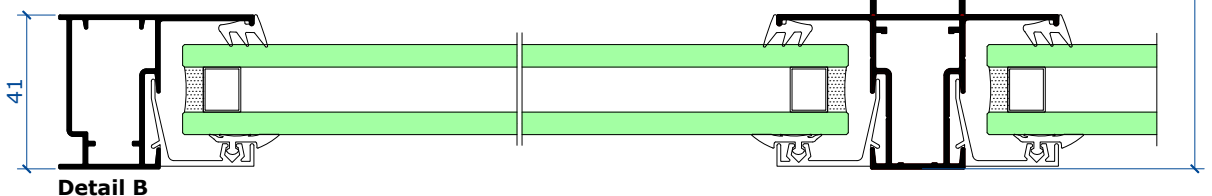

Detail A

Detail B



Double Glazed Casement

- for the Fabricator

**Accredited Laboratory
Test Certificate**
SANS 613:2011

THIS CERTIFICATE RECORDS THE SUCCESSFUL TESTING OF THE TEST SAMPLE INDICATED BELOW IN ACCORDANCE WITH SOUTH AFRICAN FENESTRATION PRODUCT STANDARD SANS613:2011 excl. par. 5.7

A3 PERFORMANCE CLASS	MANUFACTURER: HBS ALUMINIUM SYSTEMS	WATER PRESSURE: 400 [PA]
	TEST SAMPLE: WINDOW WALL CASEMENT	DEFLECTION PRESSURE: 2000 [PA]
	SYSTEM SUPPLIER: HBS ALUMINIUM SYSTEMS	STRUCTURAL PRESSURE: 3000 [PA]
	TEST NUMBER: HBS18/06	AIR INFILTRATION: 0.556 [L/sec/m ²]

DATE OF ISSUE: 18/01/2019

TEST SAMPLE DETAILS:
DESCRIPTION: WINDOW WALL CASEMENT

TEST SAMPLE ELEVATION:

DRAWING NAME: HBS18-06
NO. OF PAGES: 16

PROFILES USED ON TEST SAMPLE (CODE & DESCRIPTION):

MULLION: AB253 + ARP305(76x38 BOX)
TRANSOM: AR253
FRAME SILL: AB256 EQUAL LEG
FRAME TOP: AB256
FRAME JAMB: AB256
SASH: AB257 IN-LINE SASH
MULTI-POINT LOCK SYSTEM

GLASS USED ON TEST SAMPLE (DESCRIPTION & THICKNESS):
GLASS TYPE 1: 8.38mm LAMINATED

PRECISION FABRICATION

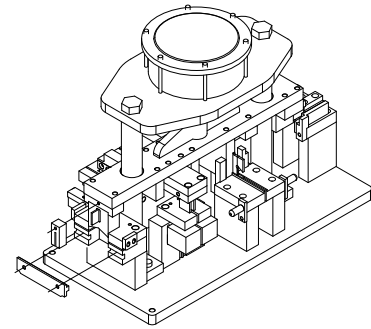

- The only Casement system that uses a Pneumatic Punch tool.
- Easy, quick punching.
- Increased productivity.
- Cost-effective.
- Reduces wastage & incorrect machining.

PRODUCT PERFORMANCE

- High product performance due to quick and easy assembly.
- A3 performance rated (SANS613:2011) 2000Pa coastal/inland.

PERFORMANCE CHART

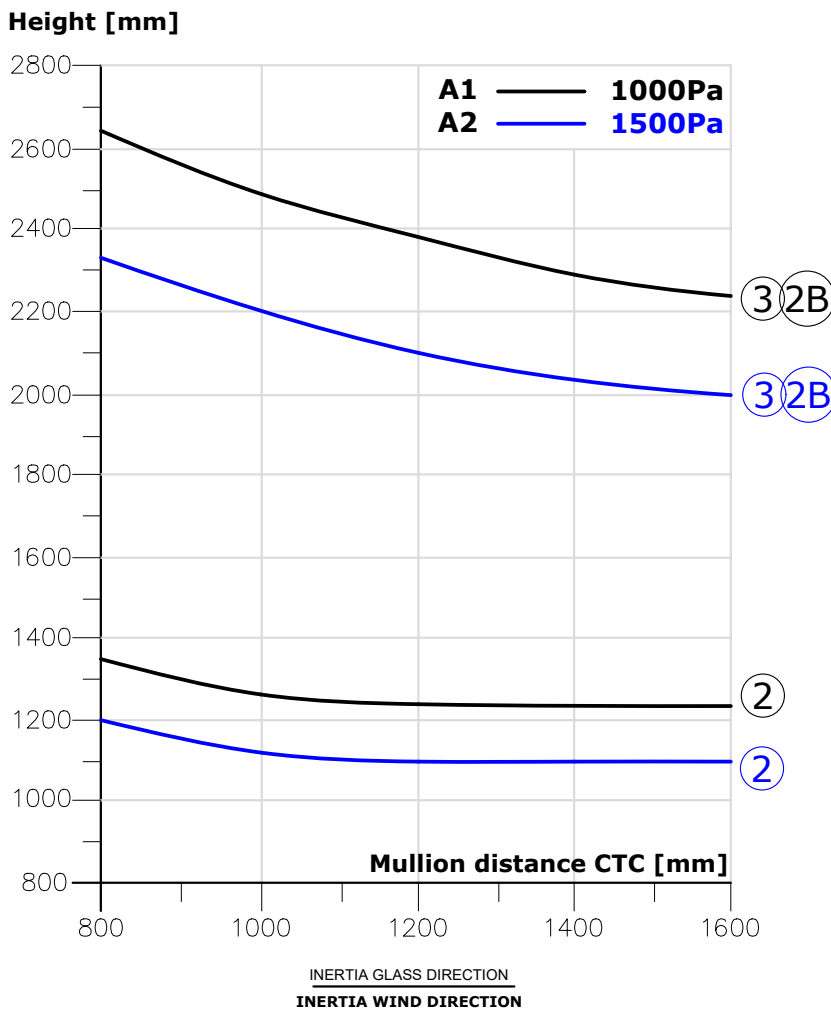

GLASS & GLAZING

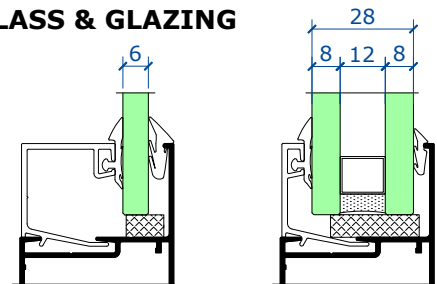

- U-values below 3.0 with SIG units.
- Uses Window Wall glazing beads.
- 25mm high glazing rebate provides full cover of the SIG glazing spacer.

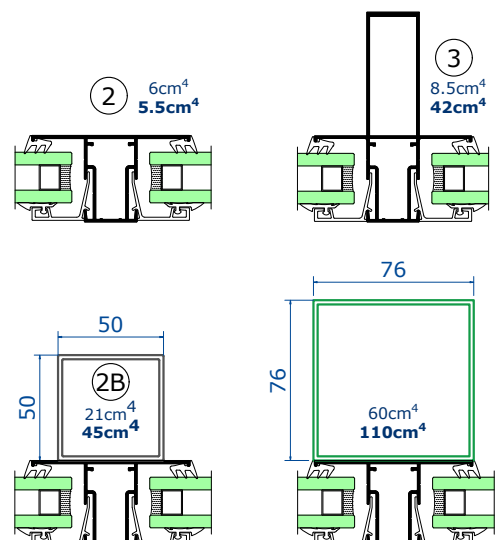

REASONS WHY ARCHITECTS, FABRICATORS AND HOME OWNERS LOVE DOUBLE GLAZED CASEMENT

1. CASEMENT DOUBLE GLAZING

This system allows for good thermal and acoustic performance and the inline, flush vents result in a clean and seamless finish.

2. TESTED TO THE LIMIT

Compliance to SANS613 A3 performance class allows it to be specified and installed in almost all occurring conditions in South Africa and regionally.

3. SIMPLE AND ACCURATE FABRICATION

Fewer components, in conjunction with the Pneumatic Punch tool will reliably produce easier, quicker, top quality products.

4. FLEXIBLE IN-LINE SASH

Designed to sit flush with the frame, the in-line sash is also adaptable to fit into Window Wall External Shopfronts, Window Wall Galaxy Sliders, Doors and Folding door systems.

5. LOCALLY STOCKED

DG Casement profiles and hardware are available off the shelf, so no extended lead times. Place the order, choose the colour and you will be fabricating and installing in no time.